

## Mounting guide ULS Mirror Panasonic PT-RQ25K and similar



This guide applies to the following variants designed for use with Panasonic RQ25K / PT-RZ24K / PT-RQ18K / PT-RZ17K projectors, depending on the lens in use and the respective mirror deflection angle. Compatible with EXACT Solutions GmbH Evo Frame P17, Panasonic Rental Frame ET-RFD65

ULS-MB-3405 / ULS Mirror Set 34/05 + MHB-4301 Projector base plate  
Mirror M340 (340 x 250 mm) + Pole 056 mm

ULS-MB-4805 / ULS Mirror Set 48/05 + MHB-4301 Projector base plate  
Mirror M480 (480 x 340 mm) + Pole 056 mm

ULS-MB-7013 / ULS Mirror Set 70/13 + MHB-4301 Projector base plate  
Mirror M700 (700 x 480 mm) + Pole 135 mm

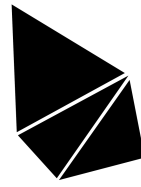

1. Place the projector base plate MHB-4301 onto the projector by using 4x M6 x 20 socket screws. Ensure that the correct side of the projector base plate is facing upward.

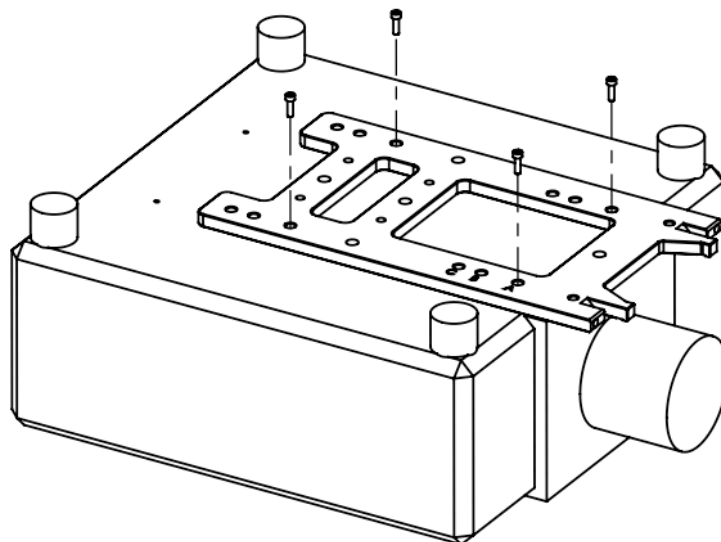
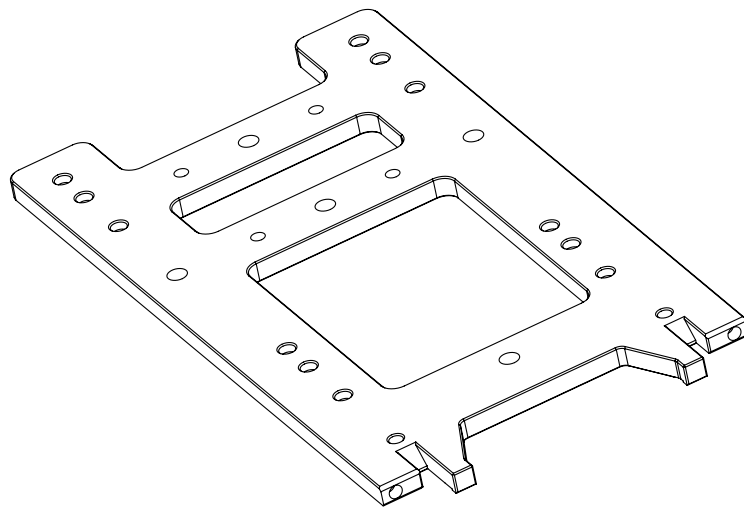

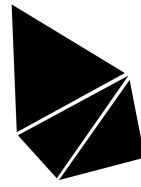

2. If a projector frame is used, mount the projector base plate MHB-4301 to the projector between frame and projector, compatible with Panasonic Rental Frame ET-RFD65 and EXACT solutions GmbH EVO FRAME P17, and fasten it using 4x M6 x 35 socket screws + washers.
- 3.

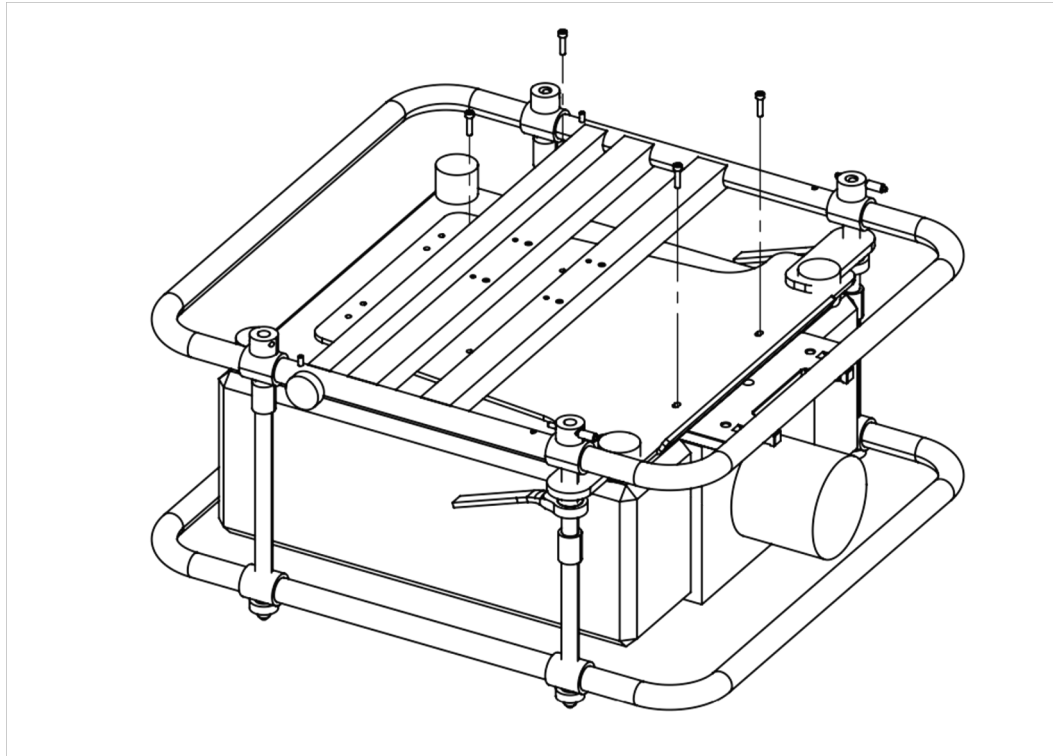

4. Mount the ULS Pole P056 onto the ULS base plate ULS-BP05 using the 4x M6 x 16 countersunk screws as shown below.

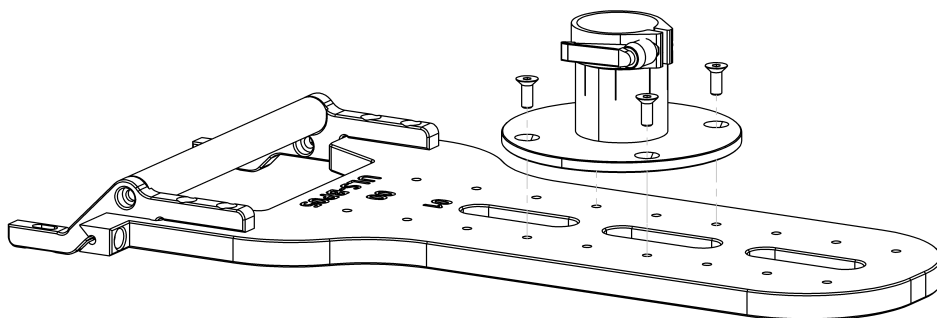

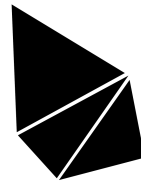

5. Mount the ULS Base plate ULS-BP05 onto the projector base plate MHB-4301 by using 2x M6 x 20 socket screw and from below 2x M6 x 10 socket screws.

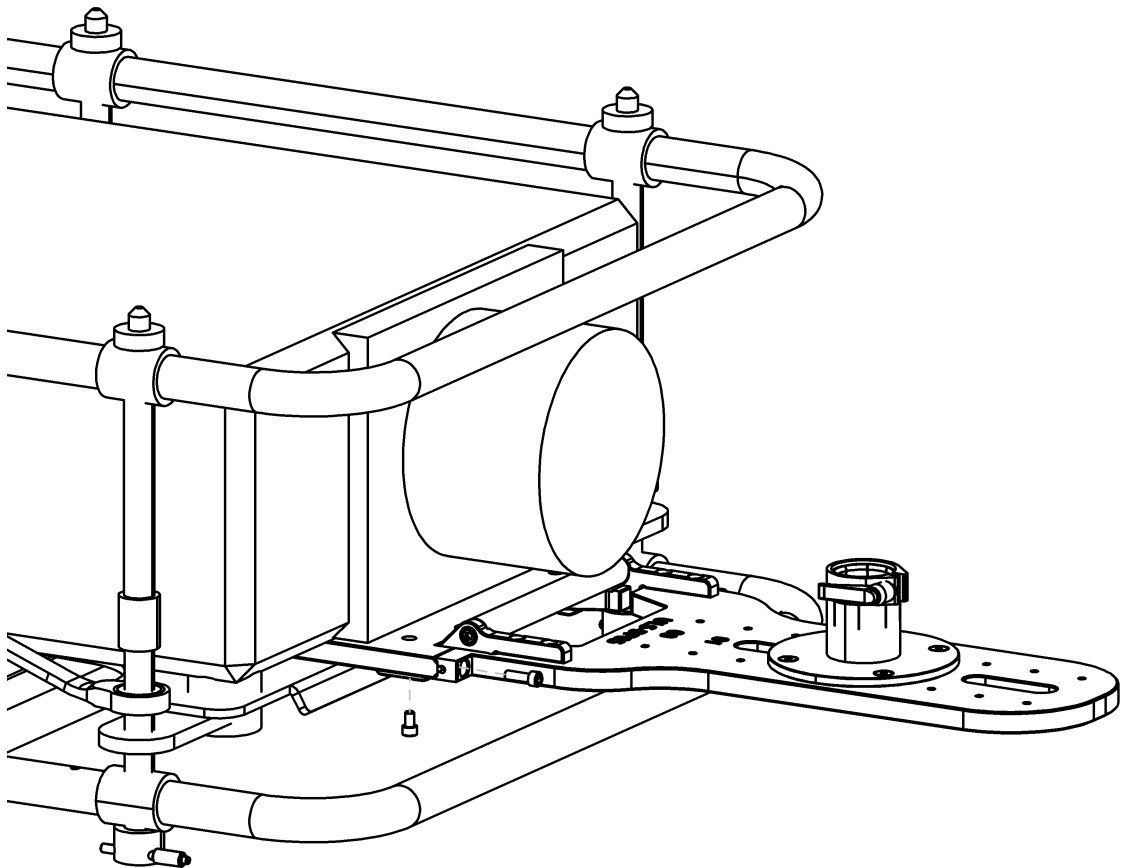

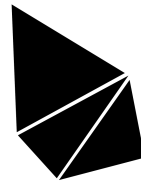

6. Mirror assembly – the figure shows a ULS-M340 mirror (340 x 250 mm)  
An M8 eye bolt is provided for attaching a safety wire. For any overhead installation, the use of a certified safety wire is mandatory.

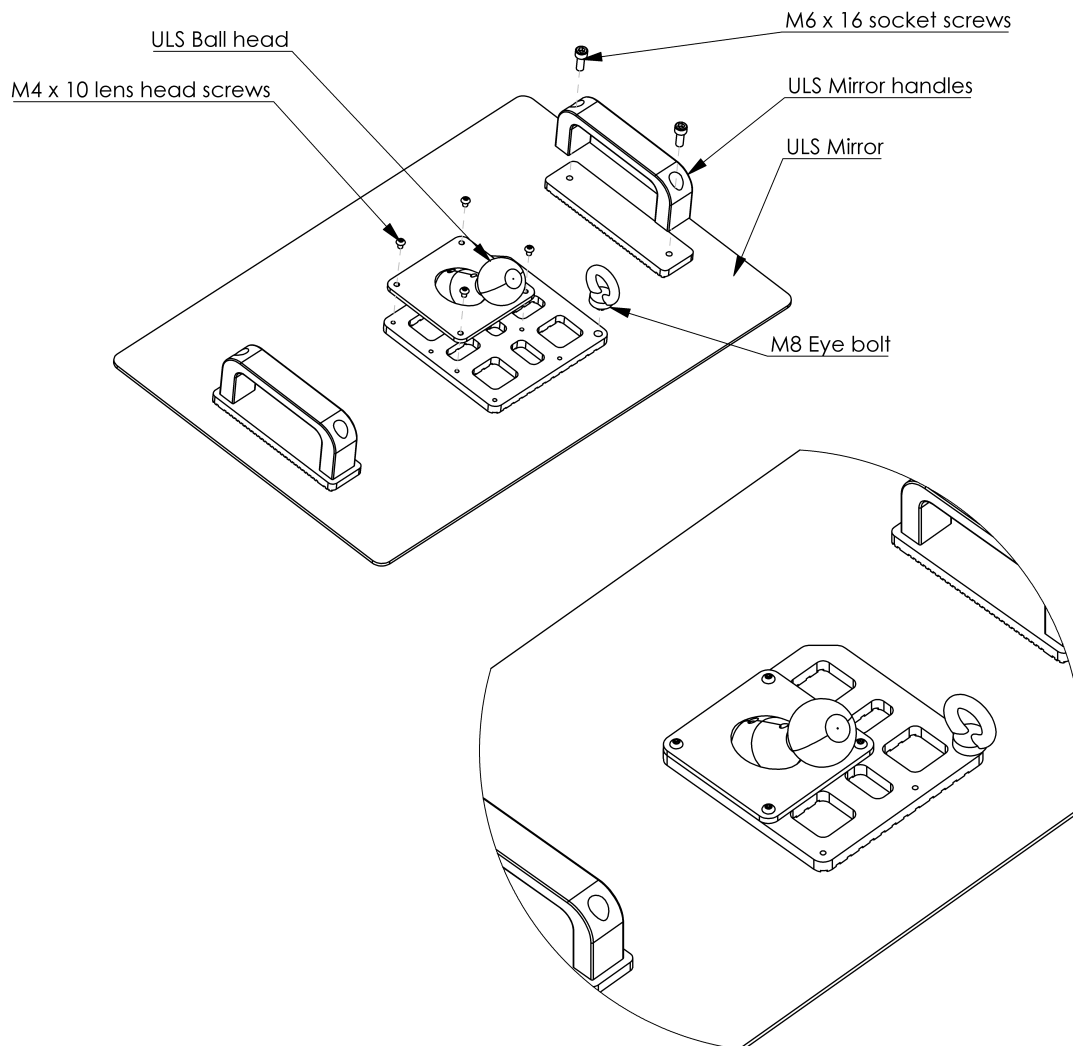

Larger mirror models such as the ULS-M480 (480 x 340 mm) and ULS-M700 (700 x 480 mm) are also available and may be required depending on the lens or throw ratio.

Larger mirrors typically need increased pole height and mounting distance for proper alignment. The appropriate mirror size and mounting setup depend on your projector's throw ratio and optical parameters.

For support with alternative configurations, please contact us.

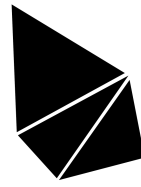

7. Place the ring clamp over the ball head, push the ball head in the ULS Pole ball socket and secure the position with the locking lever.

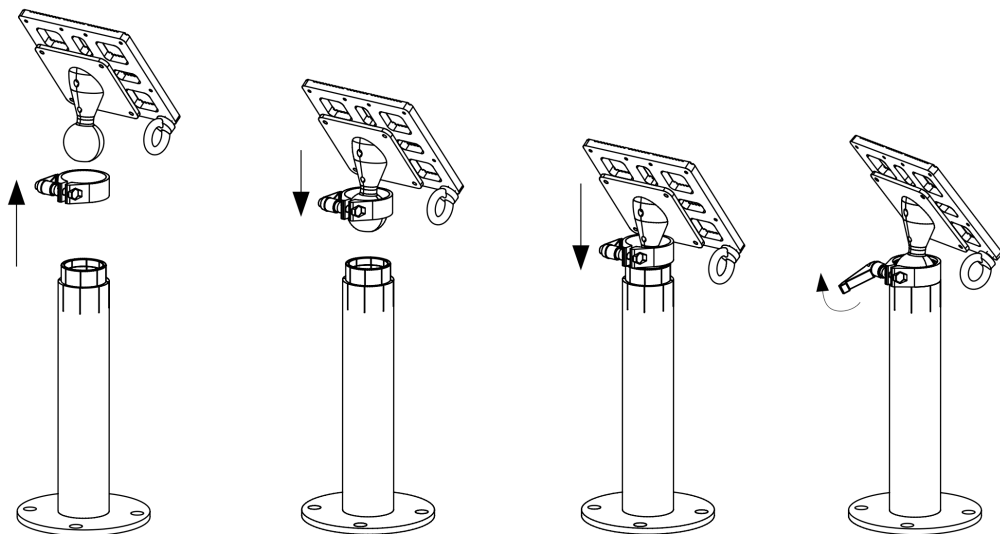
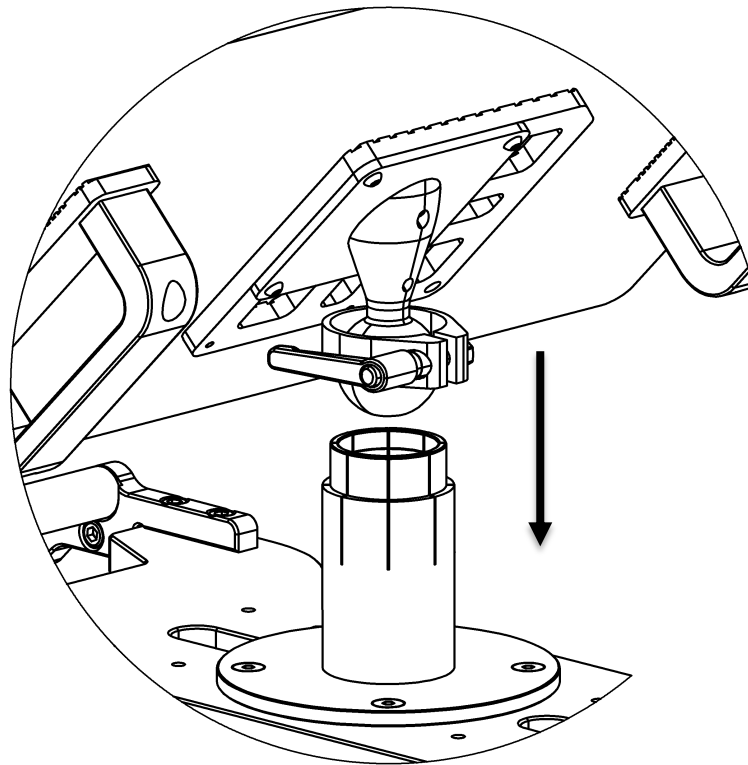

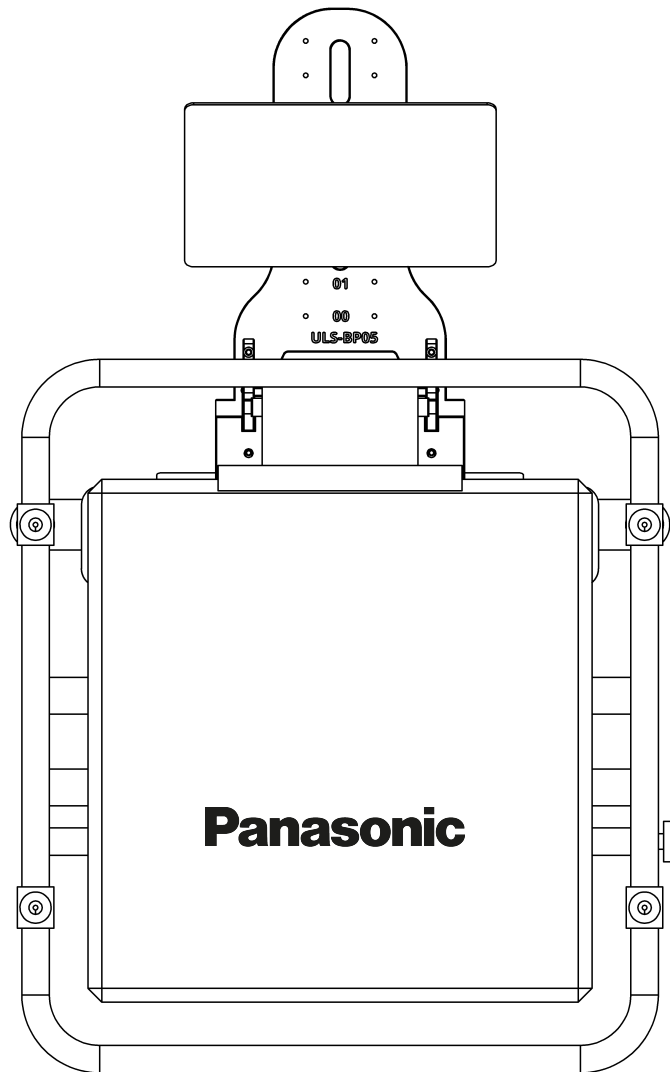
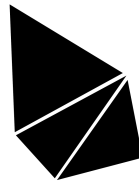

Panasonic PT-RQ25K + D3LES20, Frame EVO-P17 (ET-RFD65),  
ULS Mirror M340 (ULS Mirror Set 34/05)

Extended information regarding mounting configurations, mechanical integration, and safety instructions can be found in the official installation manual. Please consult the manual on our website for complete guidance.

<https://www.dynamicprojection.com/uls-support>