



#TheMH29 - Mirror Head 29

Barco UDM Series

A tool the industry has been waiting for. – Align and move projection positions to create fascinating shows by adding a Mirror Head to a 3-Chip DLP laser projector by Barco UDM Series, like the UDM-4K30, UDM-4K22, UDM-W30, UDM-W22 and many more.

Unlock the full potential of your projector. – Use the Mirror Head to deflect projections into multiple directions with a single projector. Reach more surfaces and project content across an entire room or any environment.

Optimized for professional show integrators. – Our state-of-the-art products are made in Austria to guarantee reliable performance and accurate projection positioning, making them powerful tools to operate at industry-levels of efficiency.

Ideal for temporary or permanent use. – The dynamic projection technology is used to design impactful visual installations and to provide flexibility when choosing the positions where video projectors are mounted.

SPECIFICATIONS MIRROR HEAD 29 WITH BARCO UDM-4K22

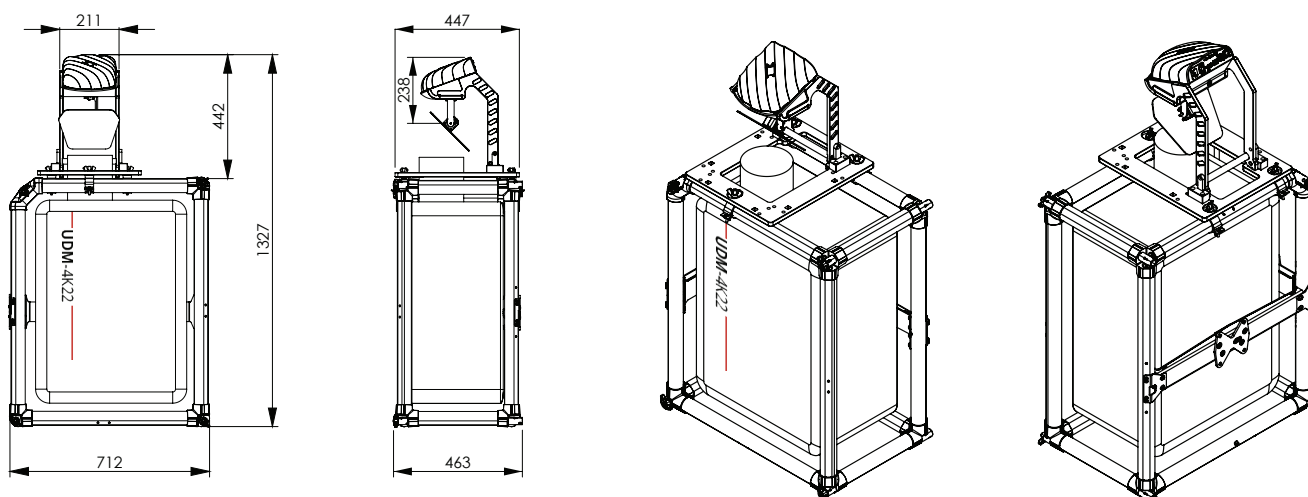

MECHANICAL SPECIFICATIONS WITH UDM-4K22

Fixture dimensions (W/D/H)	712 x 463 x 1327 mm
Fixture total with frame	99 kg
Projector UDM-4K22 + Lens	54 kg
Mirror Head MH29	9 kg

PROJECTOR COMPATIBILITY

Barco 3-chip DLP laser phosphor projectors
UDM-4K15 / UDM-4K22/ UDM-4K30
UDM-W15 / UDM-W19 / UDM-W22 / UDM-W30

IMPORTANT NOTE: For information about the specifications, operations and use of the projector carefully read the instruction manual of your projector. <https://www.barco.com/en/product/udm-4k22>

ELECTRICAL SPECIFICATIONS

INPUT POWER
100-240V / 2-1A / 50-60Hz,
Max. 10A (3-prong C14 male socket)
POWER CONSUMPTION
Max. 17W
Standby mode 3W

 Caution! There are no user serviceable parts (fuse) inside this unit.

ITEM NUMBER: MH29

Package dimensions (W/D/H): 585 x 380 x 380 mm
Package weight: 10,5kg
Package includes: Mirror Head unit, Base Plate MHB-2901, 1x MHZ-LEU lens extension, QIG, A/C power cable, 3x half coupler clamps ST812, mounting screws, metric hex key 2 mm and 5 mm.

LENS COMPATIBILITY LIST FOR BARCO UDM SERIES

Article number	R9862010 (+)	R9862020	R9862030	R9862040	R9829997
Lens type	TLD + 1.39 - 1.87:1 WUXGA	TLD + 1.87 - 2.56:1 WUXGA	TLD + 2.56 - 4.17:1 WUXGA	TLD + 4.17 - 6.95:1 WUXGA	TLD + 6.93 - 10.3:1 WUXGA
MHZ-LEU Lens extension	2x MHZ-LEU	1x MHZ-LEU	1x MHZ-LEU	—	2x MHZ-LEU

(+) NOTE: Due to optical reasons, we recommend a throw ratio over 1.5:1 to use the maximum movement spectrum of the beam deflection. It is also possible to use a lower throw ratio with certain limitations, such as: Limited mirror movement range, partial image use, spill of image edges, digitally resizing and cropping image. The mirror can be exchanged to a wider one.

MIRROR HEAD SPECIFICATIONS / FEATURES

- High resolution 16bit PAN /TILT mirror movement
- DMX-512 control over 14 DMX channels
- DMX-IN and DMX-OUT /Through port (5-pin male and female XLR connectors)
- At least 5 channels are required to control the unit
- Art-Net™ connection (RJ45) (Art-Net™ designed by and Copyright Artistic License Holdings Ltd.)
- High resolution micro step motors with maintenance free direct drive
- Self calibrating mirror position for high accuracy
- Absolute reposition accuracy smaller than 0.02°
- Movement accuracy: PAN and TILT from the same direction to the programmed point within approximately 0.01°
- RS232 remote control connection for projector (D-sub 9 male) - cable included
- Flash-able firmware (Mini USB OTG)
- High resolution LED-Display for easy configuration
- LED-Display back-light auto turn off for energy saving
- Coated mirror for optimum reflection ~98% refraction factor
- Optimized mirror optics for the specific projector
- Passive cooled system (excluding projector)
- Environmental tolerances: Ambient operating temperature range: 5°–35°C, Humidity: 20%–80% (non-condensing)
- Quick, secure and easy snap-in mounting
- Anodized light metal construction
- Pre-installed DPCC web interface for dynamic projection show creation
- HTTP Control protocol

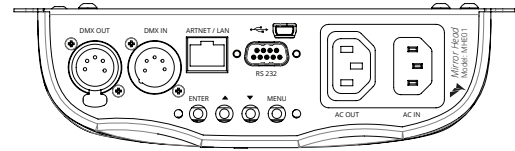

Control unit / MHE01

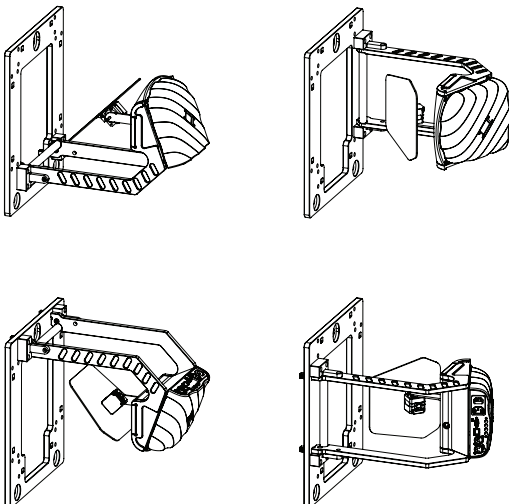
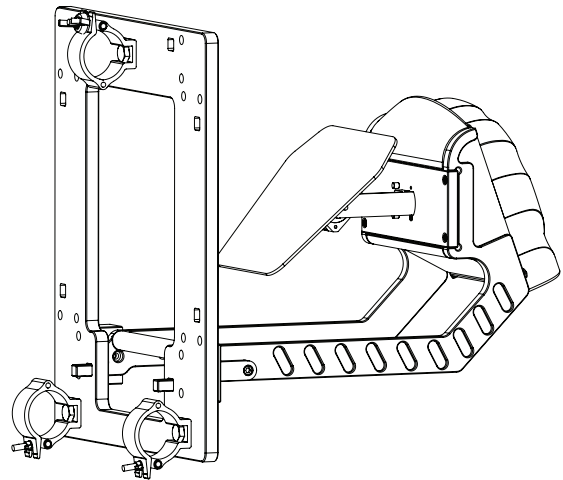

The Mirror Head MH29 and its base plate MHB-2901 allow four different mounting positions for the Mirror.

CAUTION: Secure the fixture with a safety cable (or other secondary attachments) that is approved for the weight of the fixture, so that the safety cable will hold the fixture if the primary attachment fails.

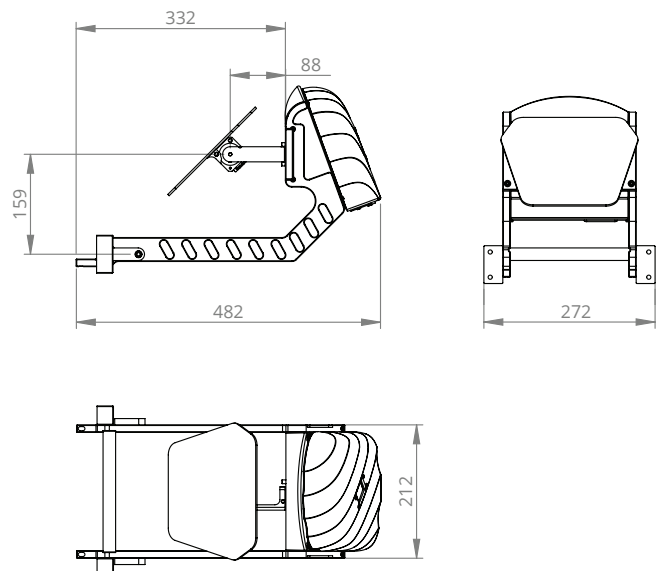

To protect the environment, please try to recycle the packing material as much as possible.

