



#TheMH29 - Mirror Head 29 BARCO UDX Series

The absolute luminary out now! – Dynamic Projection at its highest brightness ever.

A tool the industry has been waiting for. – You can now align and move projection positions and create fascinating shows with 3-chip DLP laser phosphor large venue projector by BARCO UDX Series, like the UDX-4K32, UDX-W40, UDX-U40 and many more.

Use your projectors to their full potential. – #TheMH29 is the pair of wings for your projector. Now you can easily move projection positions to reach more surfaces and project bright and colourful content across an entire room.

Ideal for staging, rental and touring. – #TheMH29 is 100% stack frame compatible with a quick, easy and secure mounting done in less than a minute while you are on the road.

It is important to note. – #TheMH29 has been designed and is produced in Austria to ensure a high-level of performance. Dynamic Projection Institute has designed this powerful tool to operate at industry-levels of efficiency and we guarantee accurate projection positioning.

SPECIFICATIONS MIRROR HEAD 29 WITH BARCO UDX-4K32

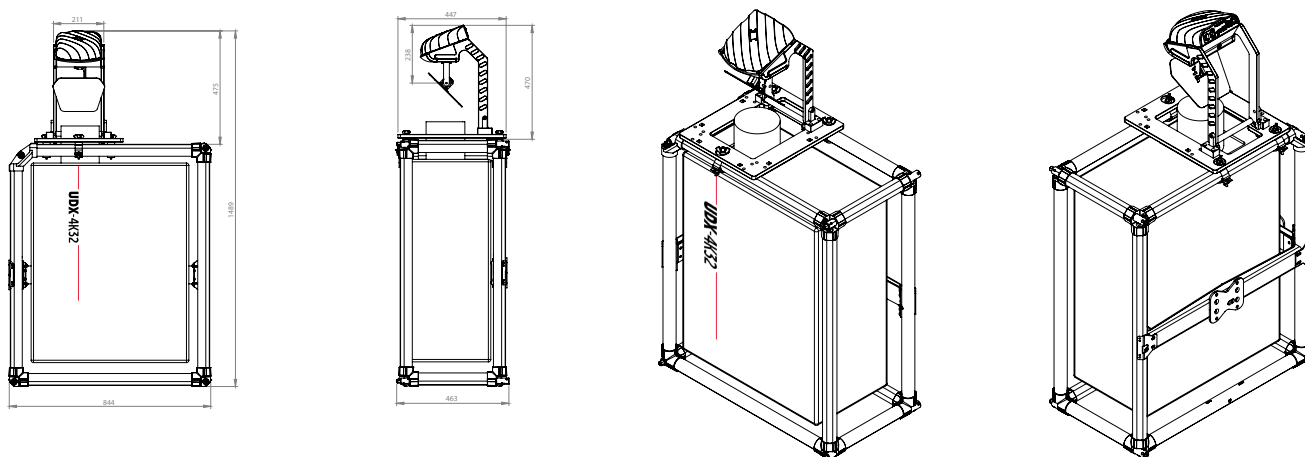

MECHANICAL SPECIFICATIONS WITH UDX-4K32

Fixture dimensions (W/D/H)	844 x 463 x 1489 mm
Fixture total with frame	130 kg
Projector UDX - 4K32 + Lens	98 kg
Mirror Head MH29	9 kg

PROJECTOR COMPATIBILITY

BARCO 3-chip DLP laser phosphor projectors
 UDX - 4K22 / UDX - 4K26 / UDX - 4K32 / UDX - 4K40
 UDX - W22 / UDX - W26 / UDX - W32 / UDX - W40
 UDX - U32 / UDX - U40 / UDX - 45LC

IMPORTANT NOTE: For information about the specifications, operations and use of the projector carefully read the instruction manual of your projector. <https://www.barco.com/en/product/udx-4k32>

ELECTRICAL SPECIFICATIONS

INPUT POWER
 100-240V / 2-1A / 50-60Hz,
 Max. 10A (3-prong C14 male socket)
 POWER CONSUMPTION
 Max. 17W
 Standby mode 3W

 Caution! There are no user serviceable parts (fuse) inside this unit.

ITEM NUMBER: MH29

- Package dimensions (W/D/H): 585 x 380 x 380 mm
- Package weight: 10,5kg
- Package includes: Mirror Head unit, MHZ-LEU lens extension, manual, A/C power cable, 3x half coupler clamps ST812, mounting screws, metric hex key 2 mm and 5 mm

LENS COMPATIBILITY LIST FOR BARCO UDX SERIES

Article number	R9862010 (+)	R9862020	R9862030	R9862040	R9829997 (+)
Lens type	TLD+ 1.39 - 1.87:1 WUXGA	TLD+ 1.87 - 2.56:1 WUXGA	TLD+ 2.56 - 4.17:1 WUXGA	TLD+ 4.17 - 6.95:1 WUXGA	TLD+ 6.93 - 10.3:1 WUXGA
MHZ-LEU Lens extension	×	—	—	—	×

(+) NOTE: Due to optical reasons we recommend a throw ratio above 1.6:1.

MIRROR HEAD SPECIFICATIONS / FEATURES

- High resolution 16bit Pan / Tilt mirror movement
- DMX-512 control over 14 DMX channels
- DMX-IN and DMX-OUT / Through port (5-pin male and female XLR connectors)
- 14 DMX channels are required to control the unit
- Art-Net™ connection (RJ45) (Art-Net™ designed by and Copyright Artistic License Holdings Ltd.)
- High resolution micro step motors with maintenance free direct drive
- Self calibrating mirror position for high accuracy
- Absolute reposition accuracy smaller than 0.03°
- Movement accuracy: Pan and Tilt from the same direction to the programmed point within approximately 0.01°
- Flash-able firmware (Mini USB OTG)
- High resolution LED-Display for easy configuration
- LED-Display back-light auto turn off for energy saving
- LED-Display Flip / Flop mode for easy reading in difficult positions
- Coated mirror for optimum reflection $\sim 98\%$ refraction factor
- Optimized mirror optics for the specific projector
- Passive cooled system (excluding projector)
- Environmental tolerances: Ambient operating temperature range: $5^\circ - 35^\circ\text{C}$, Humidity: $20\% - 80\%$ (non-condensing)
- Quick, secure and easy snap-in mounting
- Anodized light metal construction

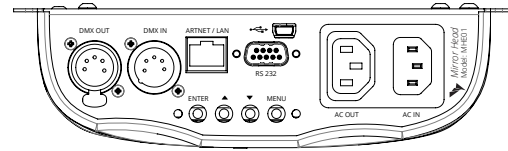

Control unit / MHE01

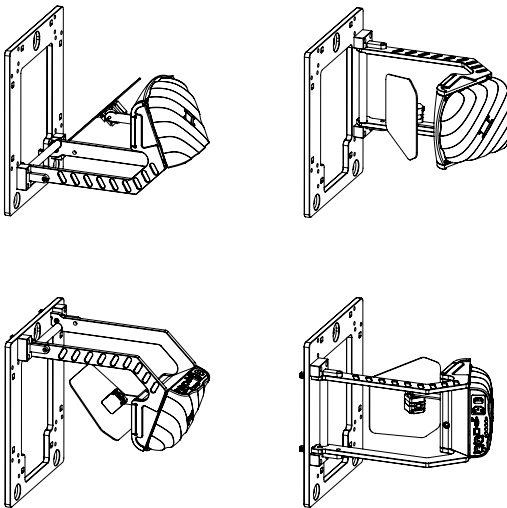
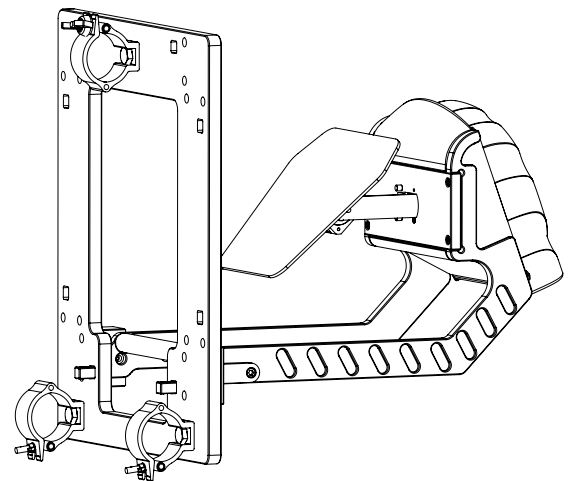

The Mirror Head MH29 and its Base Plate allow four different mounting positions for the Mirror.

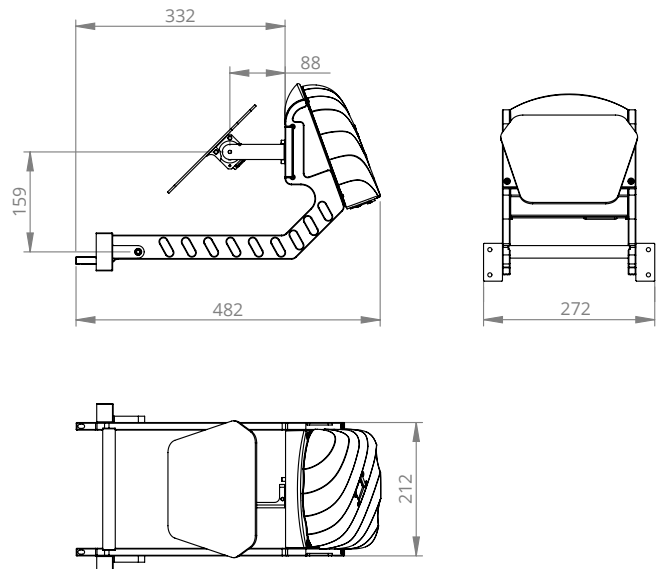

CAUTION: Secure the fixture with a safety cable (or other secondary attachments) that is approved for the weight of the fixture, so that the safety cable will hold the fixture if the primary attachment fails.



To protect the environment,
please try to recycle the packing
material as much as possible.

