



#TheMH27 – Mirror Head MH27 NEC PX2000UL

#TheMH27 – A tool the industry has been waiting for. – You can now align and move projection positions and create fascinating shows with the 1-chip DLP laser projector PX2000UL by SHARP / NEC.

Use your projectors to their full potential. – #TheMH27 is the pair of wings for your projector. You can easily move projection positions to reach more surfaces and project bright and colourful content across an entire room.

Optimized for professional show integrators. – You can easily mount the base plate to your projector to use closed-type riggings such as half-coupler clamps or any VESA mount.

Ideal for rental and touring. – #TheMH27 is equipped with a quick, easy and secure mounting done in less than a minute while you are on the road.

It is important to note. – #TheMH27 has been designed and is produced in Austria to ensure a high-level of performance. Dynamic Projection Institute has designed this powerful tool to operate at industry-levels of efficiency and we guarantee accurate projection positioning.

SPECIFICATIONS MIRROR HEAD MH27 WITH NEC PX2000UL Standard Zoom Lens T.R. 1.50 - 2.00:1

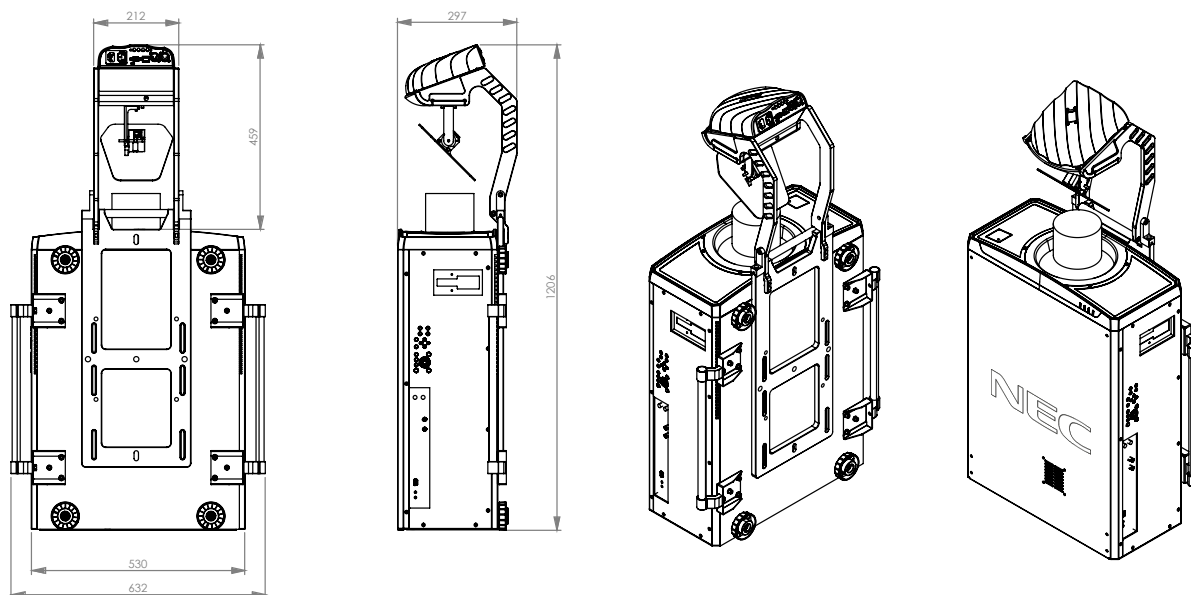

MECHANICAL SPECIFICATIONS WITH NEC PX2000UL

Fixture dimensions (W/D/H)	632 x 297 x 1210 mm
Fixture total	64 kg
Projector + Standard Zoom lens T.R. 1.50 - 2.00:1	55 kg
Mirror Head MH27	9 kg

ELECTRICAL SPECIFICATIONS

INPUT POWER
100-240V / 2-1A / 50-60Hz,
Max. 10A (3-prong C14 male socket)

POWER CONSUMPTION
Max. 17W
Standby mode 3W

PROJECTOR COMPATIBILITY

NEC PX2000UL

! Caution ! There are no user serviceable parts (fuse) inside this unit.

LENS COMPATIBILITY LIST

NP46ZL	NP47ZL	NP48ZL	NP49ZL
Zoom Lens TR: 1.20 - 1.56:1	Zoom Lens TR: 1.50 - 2.00:1	Zoom Lens TR: 2.00 - 4.00:1	Zoom Lens TR: 4.00 - 7.00:1

NOTE: Due to optical reasons we do not recommend this lens below a throw ratio of 1.6:1.

IMPORTANT NOTE: For information about the specifications, operations and use of the projector carefully read the instruction manual of your projector.

<https://www.sharpnecdisplays.eu/p/eeme/en/products/details/t/Projectors/Laser-Projectors/rp/PX2000UL.xhtml>

ITEM NUMBER: MH27

- Package dimensions (W/D/H):
675 x 400 x 350 mm
- Package weight: 12 kg / 680 x 380 x 380
- Package includes: Mirror Head unit, MHB-2701 Base Plate, QIG, RS232 cable, A/C power cable, Mounting screws, Metric Hex key 2 mm and 5 mm

MIRROR HEAD SPECIFICATIONS / FEATURES

- High resolution 16bit Pan / Tilt mirror movement
- DMX-512 control over 14 DMX channels
- DMX-IN and DMX-OUT / Through port (5-pin male and female XLR connectors)
- 14 DMX channels are required to control the unit
- Art-Net™ connection (RJ45) (Art-Net™ designed by and Copyright Artistic License Holdings Ltd.)
- High resolution micro step motors with maintenance free direct drive
- Self calibrating mirror position for high accuracy
- Absolute reposition accuracy smaller than 0.03°
- Movement accuracy: Pan and Tilt from the same direction to the programmed point within approximately 0.01°
- RS232 remote control connection for projector (D-sub 9 male) - cable included
- Flash-able firmware (Mini USB OTG)
- High resolution LED-Display for easy configuration
- LED-Display back-light auto turn off for energy saving
- LED-Display Flip / Flop mode for easy reading in difficult positions
- Coated mirror for optimum reflection ~98% refraction factor
- Optimized mirror optics for the specific projector
- Passive cooled system (excluding projector)
- Environmental tolerances: Ambient operating temperature range: 5°–35°C, Humidity: 20%–80% (non-condensing)
- Quick, secure and easy snap-in mounting
- Anodized light metal construction

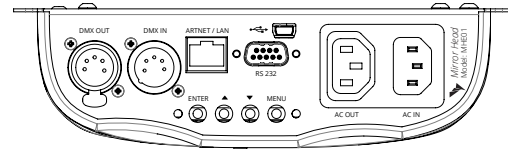

Control unit / MHE01

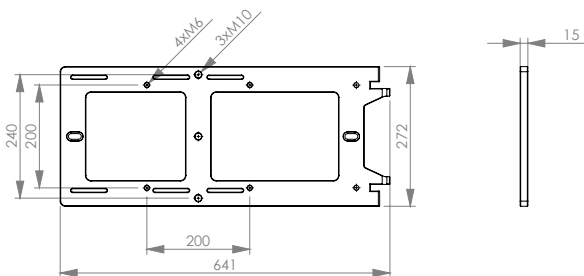
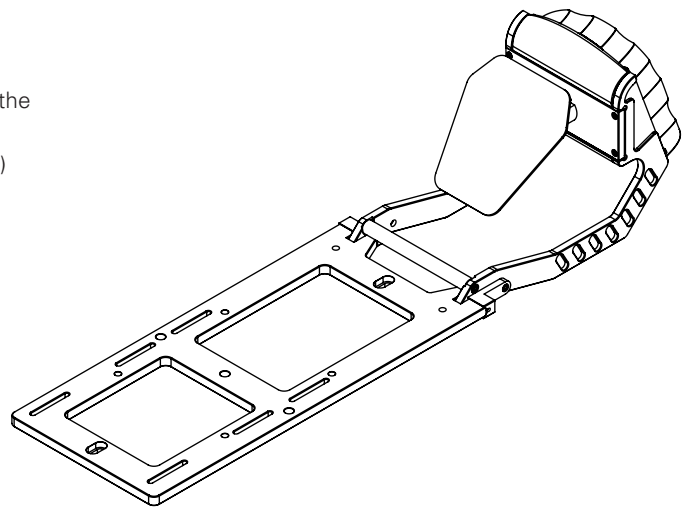

The MHB-2701 base plate supports 3 x M10 threads, two slot holes and VESA 200 with 4 x M6, max. screw depth = 15 mm.

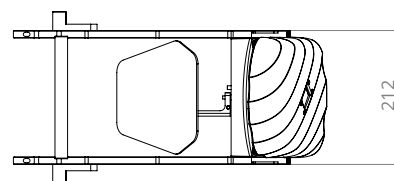
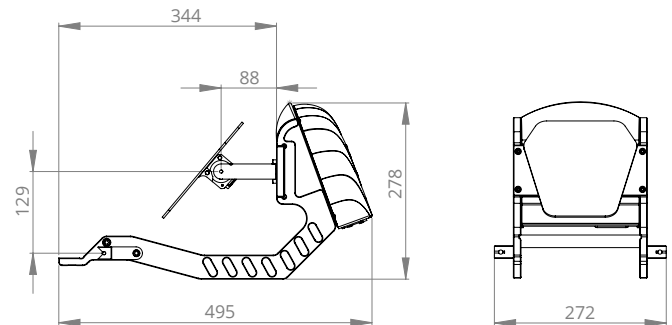
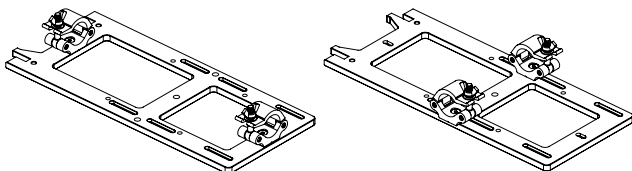

CAUTION: For the use of closed-type riggings such as half-coupler clamps secure the fixture with a safety cable (or other secondary attachments) that is approved for the weight of the fixture, so that the safety cable will hold the fixture if the primary attachment fails.



To protect the environment,
please try to recycle the packing
material as much as possible.

