



#TheMH27 – Mirror Head 27

Digital Projection M-Vision Laser

A tool the industry has been waiting for. – Align and move projection positions to create fascinating shows by adding a Mirror Head to a single chip DLP laser projectors by Digital Projection, like the M-Vision Laser 27000 WU, 23000 WU, 21000 WU and 18K.

Unlock the full potential of your projector. – Use the Mirror Head to deflect projections into multiple directions with a single projector. Reach more surfaces and project content across an entire room or any environment.

Optimized for professional show integrators. – Our state-of-the-art products are made in Austria to guarantee reliable performance and accurate projection positioning, making them powerful tools to operate at industry-levels of efficiency.

Ideal for temporary or permanent use. – The dynamic projection technology is used to design impactful visual installations and to provide flexibility when choosing the positions where video projectors are mounted.

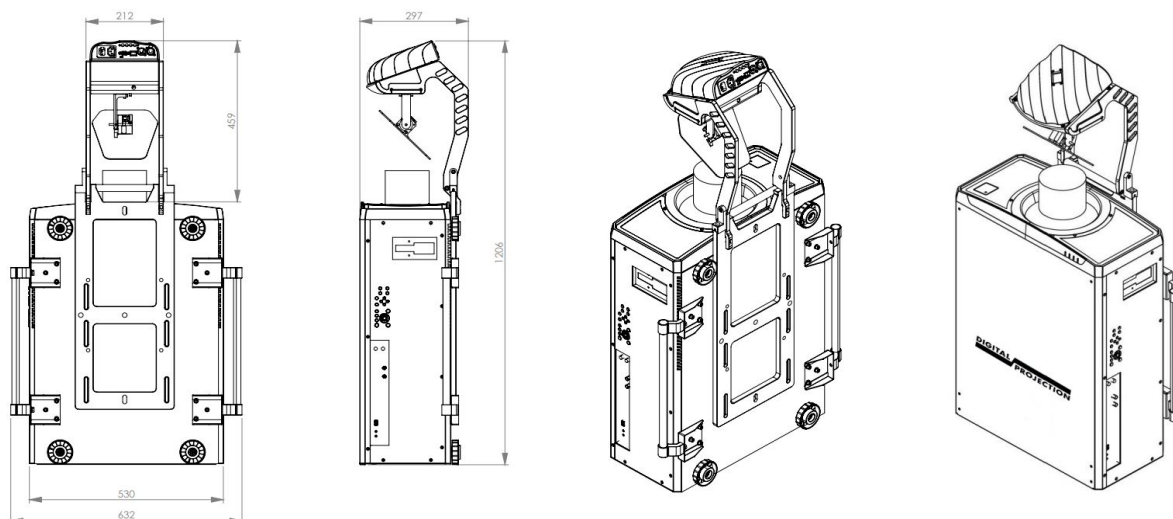

MECHANICAL SPECIFICATIONS

Fixture dimensions (W/D/H)	632 x 297 x 1210 mm
Fixture total	64 kg
Projector + Zoom lens T.R. 1.50 - 2.00:1	55 kg
Mirror Head MH27	9 kg

PROJECTOR COMPATIBILITY

M-Vision Laser 27000 WU
1920 x 1200 - 27,000 ISO / 24,000 ANSI Lumens

M-Vision Laser 23000 WU
1920 x 1200 - 23,000 ISO / 20,500 ANSI Lumens

M-Vision Laser 21000 WU
1920 x 1200 - 21,000 ISO / 18,600 ANSI Lumens

M-Vision Laser 18K
1920 x 1200 - 10,000 ISO / 16,000 ANSI Lumens

LENS COMPATIBILITY LIST

117-573	118-578	118-588	117-463
Zoom Lens TR: 1.20 - 1.56:1	Zoom Lens TR: 1.50 - 2.00:1	Zoom Lens TR: 2.00 - 4.00:1	Zoom Lens TR: 4.00 - 7.00:1

Due to optical reasons, we recommend a throw ratio over 1.5:1 to use the maximum movement spectrum of the beam deflection. It is also possible to use a lower throw ratio with certain limitations, such as: Limited mirror movement range, partial image use, spill of image edges, digitally resizing and cropping image. The mirror can be exchanged to a wider one.

ELECTRICAL SPECIFICATIONS

INPUT POWER
100-240V / 2-1A / 50-60Hz,
Max. 10A (3-prong C14 male socket)
POWER CONSUMPTION
Max. 17W
Standby mode 3W

 Caution! There are no user serviceable parts (fuse) inside this unit.

ITEM NUMBER: MH27

- Package dimensions (W/D/H):
675 x 400 x 350 mm
- Package weight: 12 kg
- Package includes: Mirror Head unit, Base Plate MHB-2701, RS232 cable, A/C power cable, Mounting screws, Metric Hex key 2 mm and 5 mm

IMPORTANT NOTE: For information about the specifications, operations and use of the projector carefully read the instruction manual of your projector.

<https://www.digitalprojection.com/en/projectors/m-vision-27000-wu/>

MIRROR HEAD SPECIFICATIONS / FEATURES

- High resolution 16bit PAN /TILT mirror movement
- DMX-512 control over 14 DMX channels
- DMX-IN and DMX-OUT /Through port (5-pin male and female XLR connectors)
- At least 5 channels are required to control the unit
- Art-Net™ connection (RJ45) (Art-Net™ designed by and Copyright Artistic License Holdings Ltd.)
- High resolution micro step motors with maintenance free direct drive
- Self calibrating mirror position for high accuracy
- Absolute reposition accuracy smaller than 0.02°
- Movement accuracy: PAN and TILT from the same direction to the programmed point within approximately 0.01°
- RS232 remote control connection for projector (D-sub 9 male) - cable included
- Flash-able firmware (Mini USB OTG)
- High resolution LED-Display for easy configuration
- LED-Display back-light auto turn off for energy saving
- Coated mirror for optimum reflection ~98% refraction factor
- Optimized mirror optics for the specific projector
- Passive cooled system (excluding projector)
- Environmental tolerances: Ambient operating temperature range: 5°–35°C, Humidity: 20%–80% (non-condensing)
- Quick, secure and easy snap-in mounting
- Anodized light metal construction
- Pre-installed DPCC plug-n-play solution to use a Mirror Head directly from a web browser and any operating system
- HTTP Control protocol

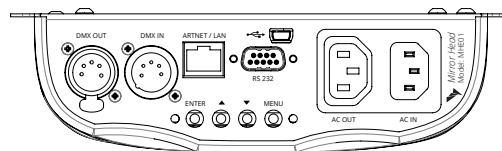

Control unit / MHE01

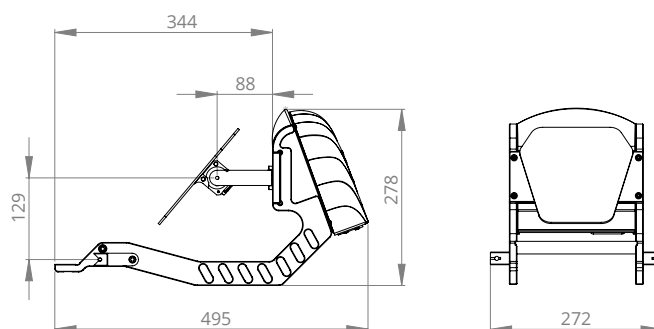
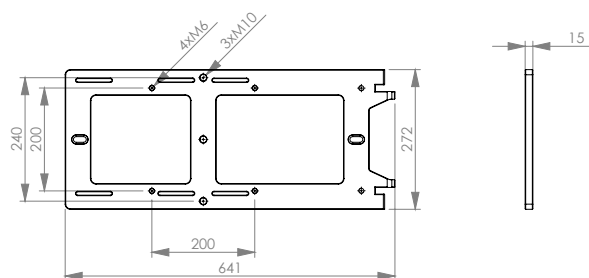
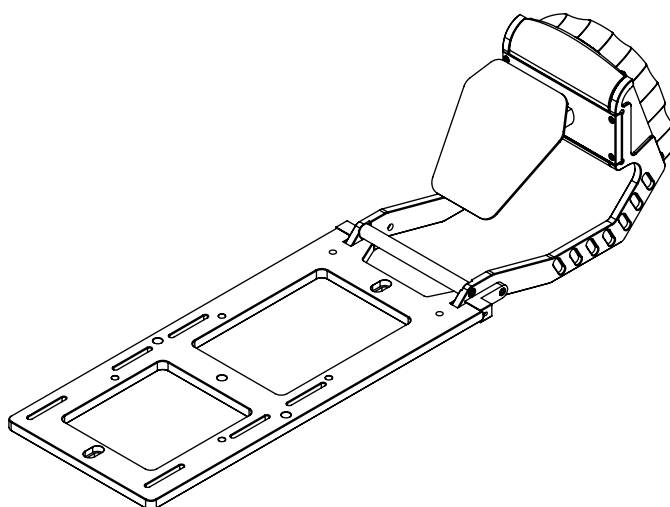

The MHB-2701 base plate supports 3 x M10 threads, two DM 11mm slot holes and VESA 200 with 4 x M6, max. screw depth = 15 mm.

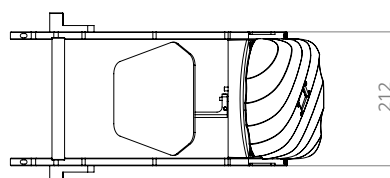
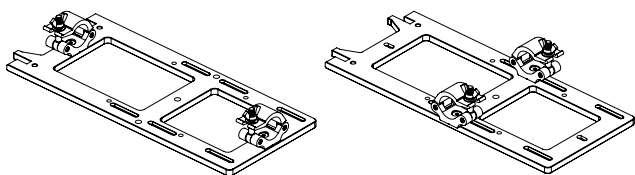

CAUTION: For the use of closed-type riggings such as half-coupler clamps secure the fixture with a safety cable (or other secondary attachments) that is approved for the weight of the fixture, so that the safety cable will hold the fixture if the primary attachment fails.

To protect the environment, please try to recycle the packing material as much as possible.

